

4

3

2

1

B

B

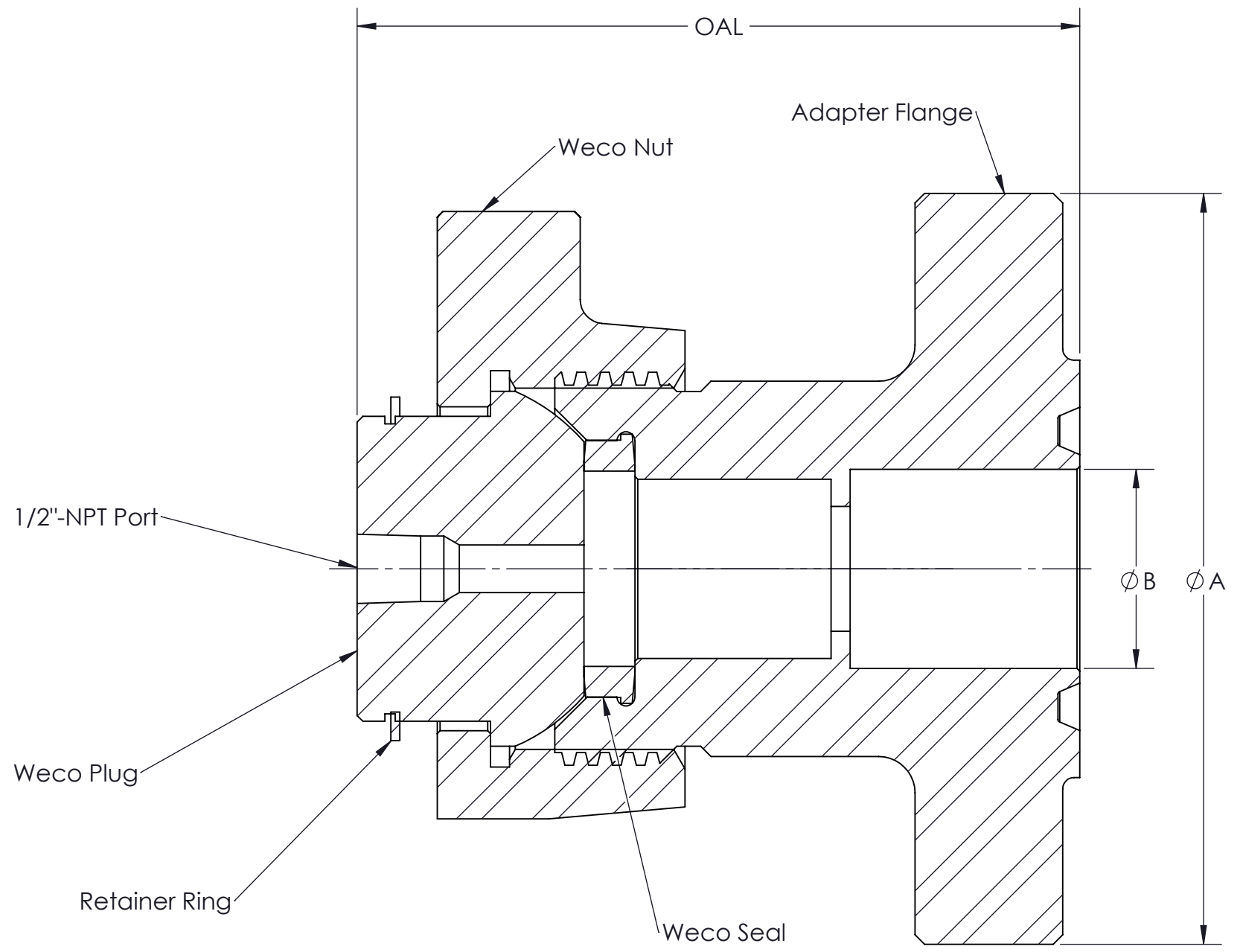

Diameters A & B are per the API 6A Flange Dimensions
 OAL is per P.O.

A

A

PROPRIETARY AND CONFIDENTIAL
 THE INFORMATION CONTAINED IN THIS DRAWING IS THE SOLE PROPERTY OF HESHKA OIL. ANY REPRODUCTION IN PART OR AS A WHOLE WITHOUT THE WRITTEN PERMISSION OF HESHKA OIL IS PROHIBITED.

REV.	ECN Number	Date

UNLESS OTHERWISE SPECIFIED:
 DIMENSIONS ARE IN INCHES
 TOLERANCES:
 FRACTIONAL ±1/64"
 ANGULAR: ±1/2 Degree
 x.x ±.03
 x.xx ±.01
 x.xxx ±.005
 Surface Finish 125RMS Unless Otherwise Noted
 (X.XXX) INDICATES CRITICAL DIMENSION TO BE INSPECTED

MATERIAL
 Per P.O.

FINISH
 DO NOT SCALE DRAWING

	NAME	DATE
DRAWN	MJP	9/14/2022
CHECKED	MP	9/14/2022
ENG APPR.		
MFG APPR.		
Q.A.		
COMMENTS:		

TITLE: GA		
API 6A Flange x 1502 WECO Connection		
SIZE	DWG. NO.	REV
B	H09142022-GA	A
SCALE: NTS	WEIGHT:	SHEET 1 OF 1

4

3

2

1